



Chains

Product Catalogue



# Contents

<b>Welcome</b>	<b>3</b>
<b>Development of plastic chains</b>	<b>4</b>
<b>FT70</b>	<b>5</b>
<b>RT114</b>	<b>6</b>
<b>RTF70</b>	<b>7</b>
<b>RTF114</b>	<b>8</b>
<b>FT54</b>	<b>9</b>
<b>KLDH50</b>	<b>10</b>

# Welcome to the world of Conveyor Solutions

Fredriksons Verkstads AB, established in Sweden 1917, is a modern mechanical manufacturing industry specialized in working with stainless steel, carbon steel and aluminum.

Conveyor Solutions offer complete solutions, from development to production, installation and service. Our product portfolio consists of package conveyors, vertical conveyors, accumulators, elevators and other handling systems.

This catalogue contains our chains. Separate product overviews in the catalogue present basic information about the different chains.

Please visit our website or contact us for more information regarding our products.

## [www.conveyorsolutions.se](http://www.conveyorsolutions.se)

Fredriksons Verkstads AB  
Box 148  
SE-592 23 Vadstena  
Sweden  
Phone: +46(0)143 296 00

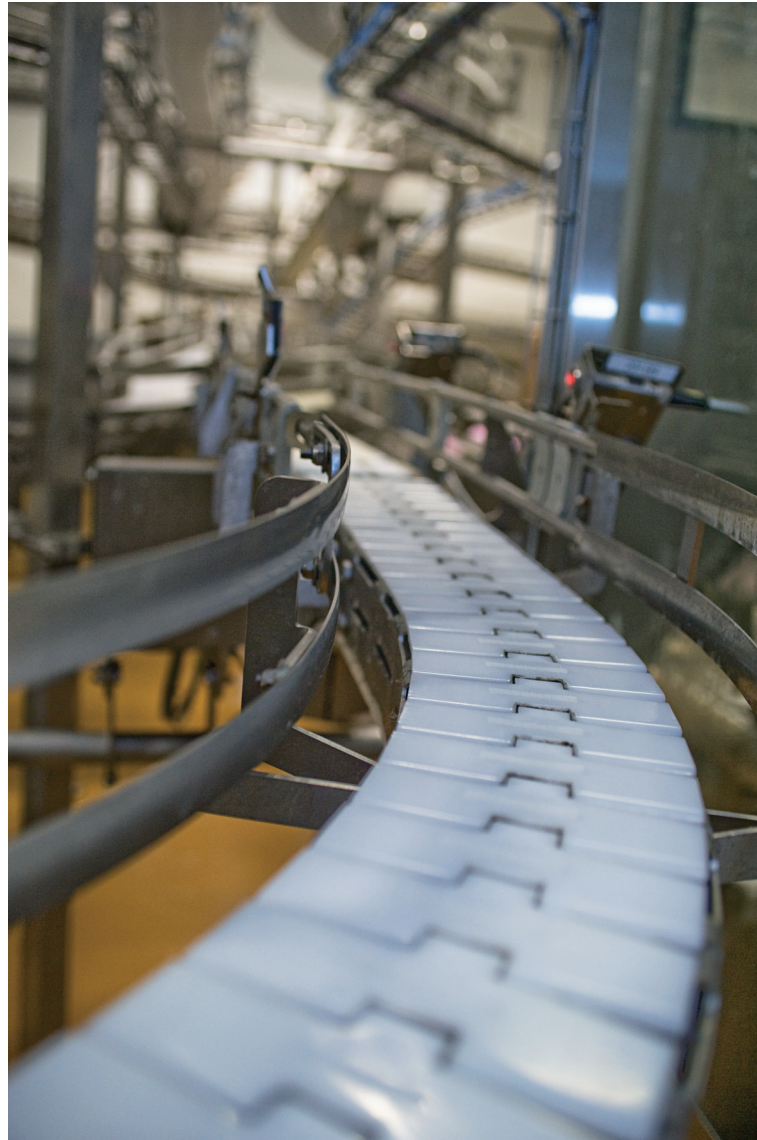

## **Development of plastic chains**

**For more than 40 years, Fredriksons has developed plastic chains for the food and beverage industry.**

**The original cardan link chain, invented in our engineering department, has been developed during the years. We are now proud to offer a range of chains in accordance with the most demanding standards, like BS EN 619.**

**We always try to improve our chains to reduce friction between conveyor body and chain. Thus, we aim to offer chains with the longest life to reduce cost and spare our environment.**

**The plastic chains together with our conveyor systems, primary packaging and secondary packaging, offer complete logistic solutions. Whether you use our chains in our conveyor solutions or in your own products we can always assist you with our knowledge.**

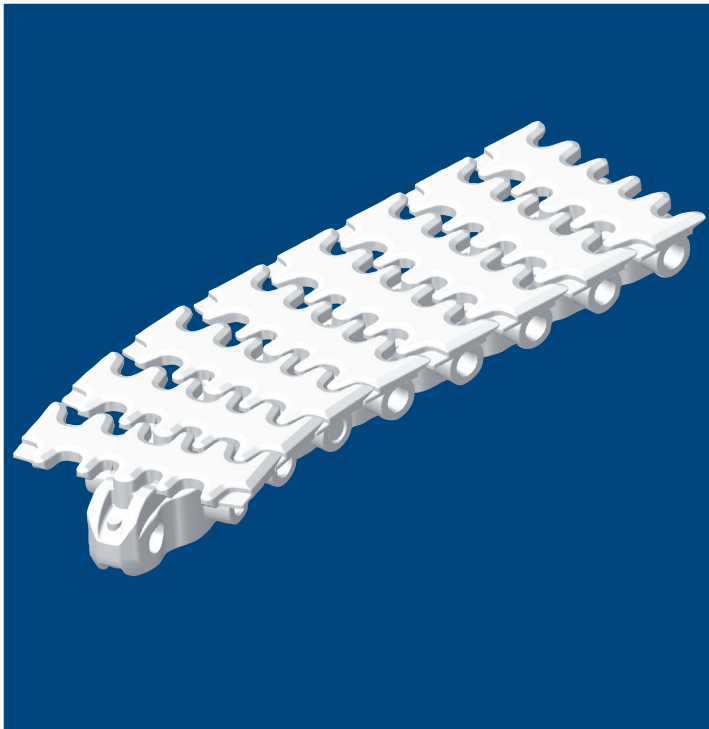

## FT70

A plastic chain developed according to safety regulations BS EN619 standard. Recommended surrounding temperature is -18 — +50 °C. Recommended maximum work load at 20 °C is 100 kp/1000 N.

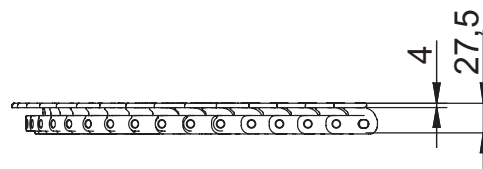
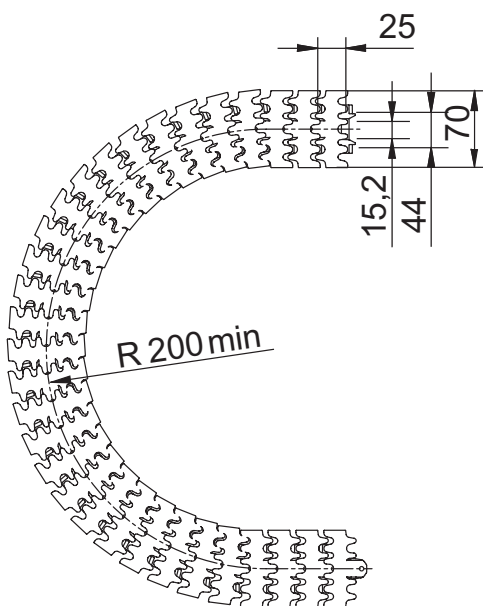

(mm)

Part number	Material	Length (L)	Weight	Width	Volume	Colour
3019400-0101	POM Link: Low friction ACETAL Moisture pickup 0.2 % Rivet: Stainless steel	10 m per box	16 kg/10 m	70 mm	25.3 dm <sup>3</sup> /10 m	White
3113504-0101	PBT Link: Low friction acid resistance Rivet: Stainless steel	10 m per box	16 kg/10 m	70 mm	25.3 dm <sup>3</sup> /10 m	Grey

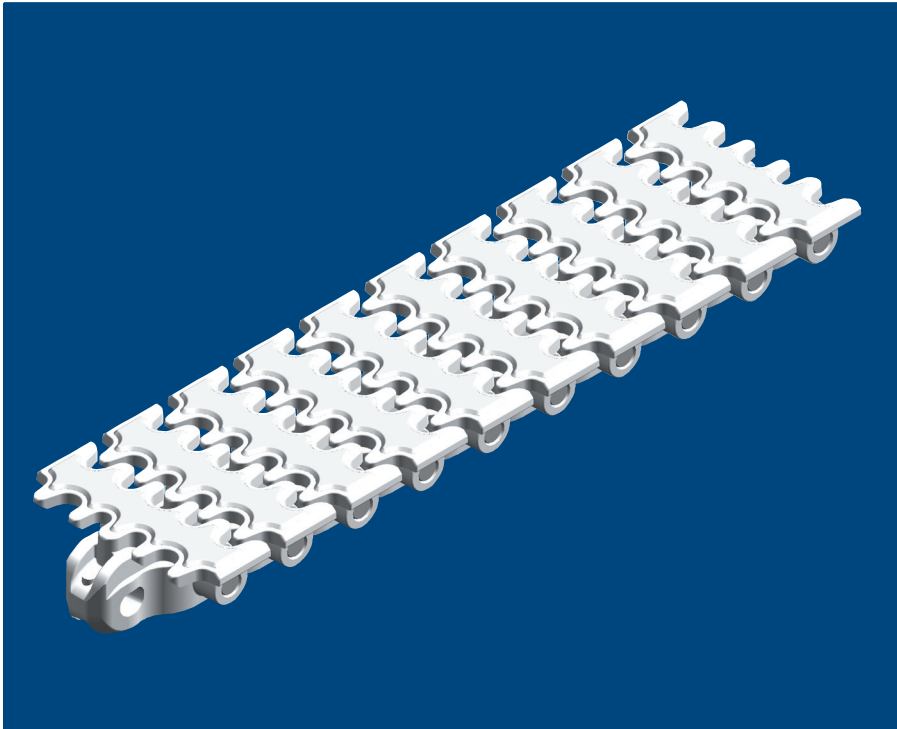

## RTF70

A plastic chain with a friction surface. Recommended surrounding temperature is -18 — +50 °C. Recommended maximum work load at 20 °C is 100 kp/1000 N.

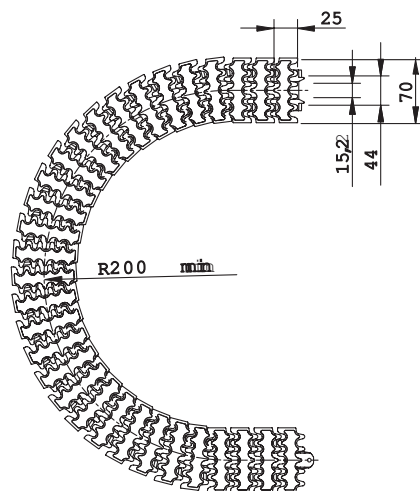
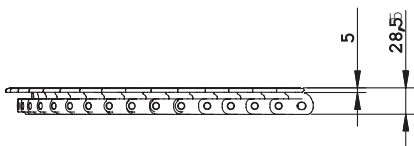

(mm)

Part number	Material	Length (L)	Weight	Width	Volume
F206604-101	POM Link: Low friction ACETAL Moisture pickup 0.2 % Rivet: Stainless steel Friction surface: TPE	10 m per box	16 kg/10 m	70 mm	25.3 dm <sup>3</sup> /10 m

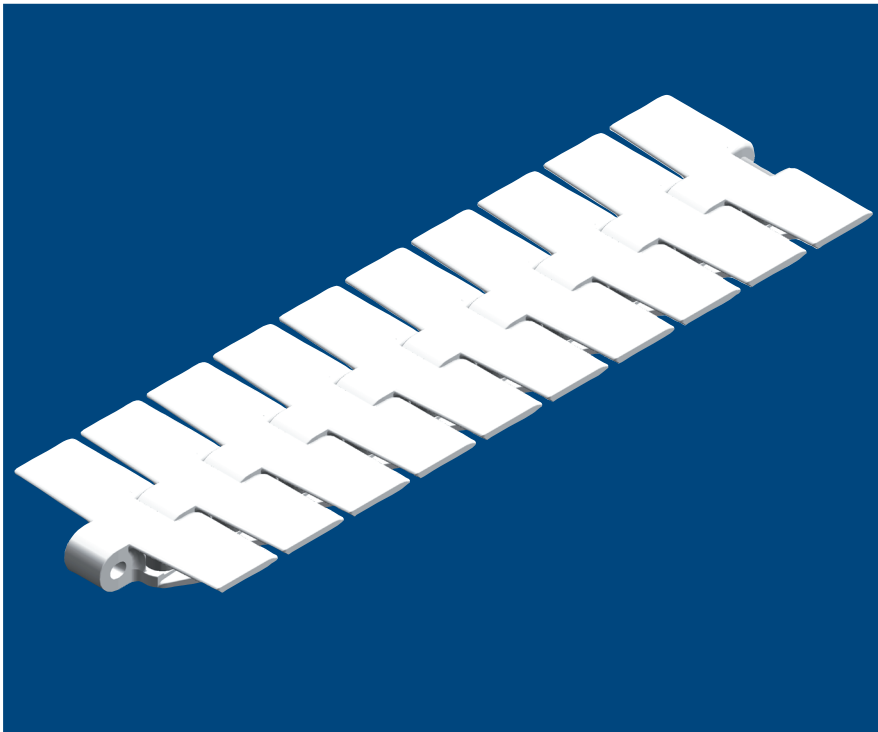

## RT114

A plastic chain developed according to safety regulations BS EN619 standard. Recommended surrounding temperature is -18 — +50 °C.

Recommended maximum work load at 20 °C is 200 kp/2000 N.

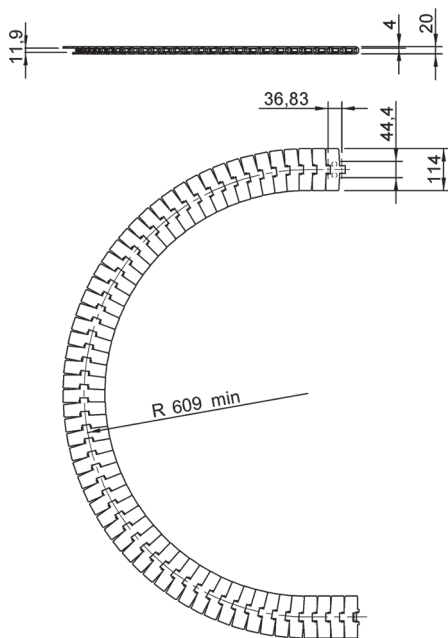

(mm)

Part number	Material	Length (L)	Weight	Width	Volume
3019350	POM Link: Low friction ACETAL POLYAMID Moisture pickup 0.2 % Rivet: Stainless steel	3 m per box	5 kg/3 m	114 mm	9.25 dm <sup>3</sup> /3 m

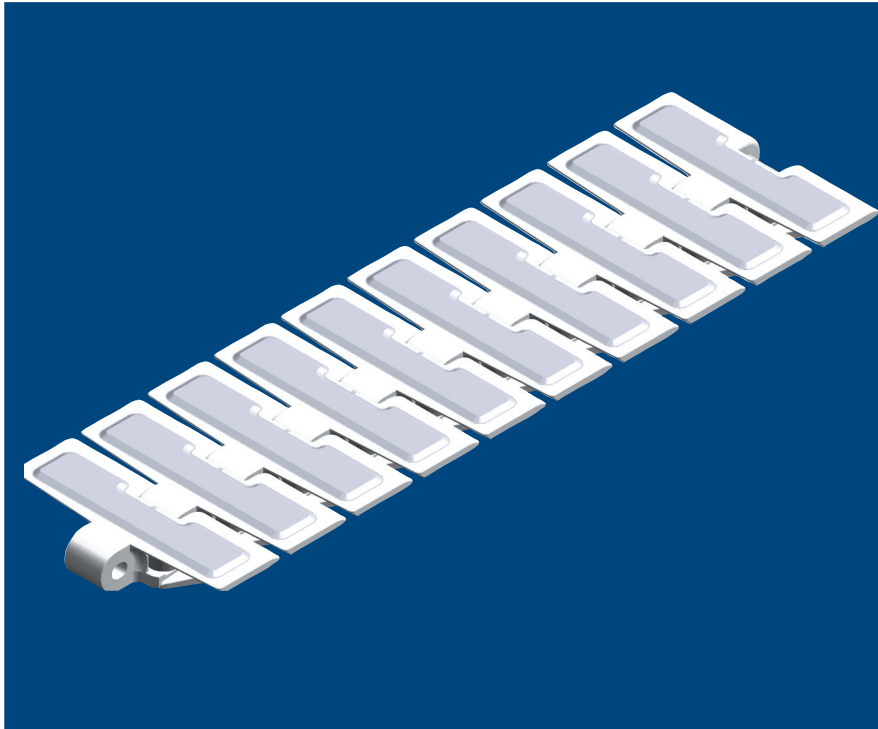

## RTF114

A plastic chain with a friction surface. Recommended surrounding temperature is -18 — +50 °C.

Recommended maximum work load at 20 °C is 200 kp/2000 N.

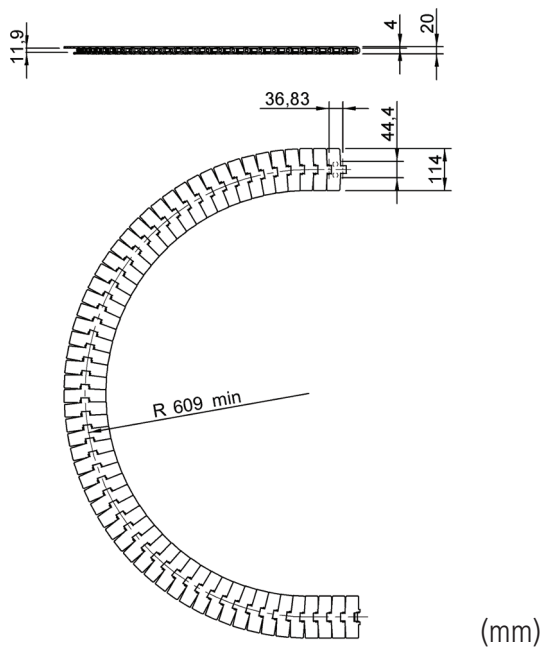

Part number	Material	Length (L)	Weight	Width	Volume
F205728-101	POM Link: Low friction ACETAL POLYAMID Moisture pickup 0.2 % Rivet: Stainless steel Friction surface: TPE	3 m per box	5 kg/3 m	114 mm	9.25 dm <sup>3</sup> /3 m



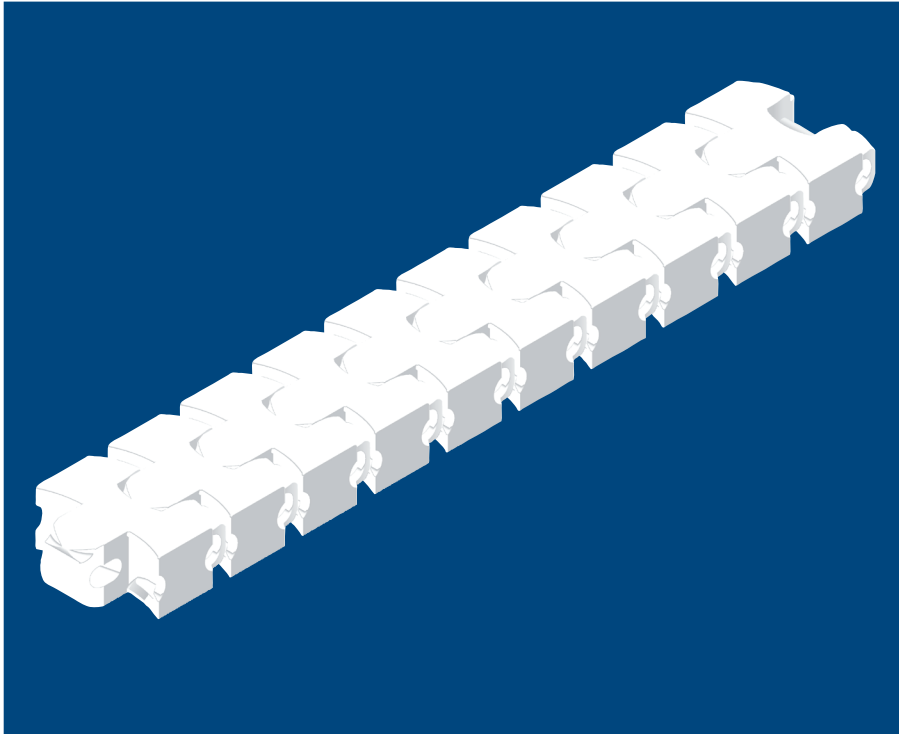

## FT54

A plastic chain. Recommended surrounding temperature is -18 — +50 °C. Recommended maximum work load at 20 °C is 200 kp/2000 N.

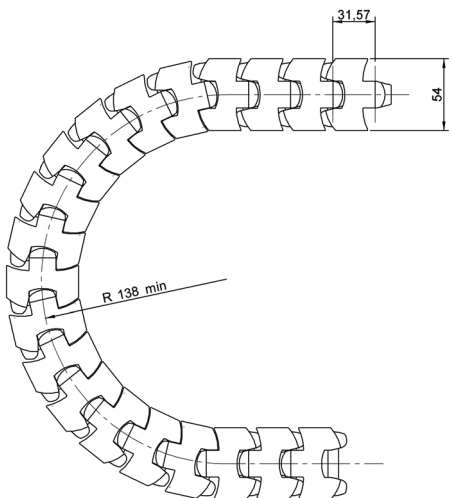

(mm)

Part number	Material	Length (L)	Weight	Width	Volume
1550500-0101-1	POM Link: Low friction ACETAL Moisture pickup 0.2 % Rivet: Stainless steel	10 m per box	18 kg/10 m	54 mm	17.5 dm <sup>3</sup> /10 m

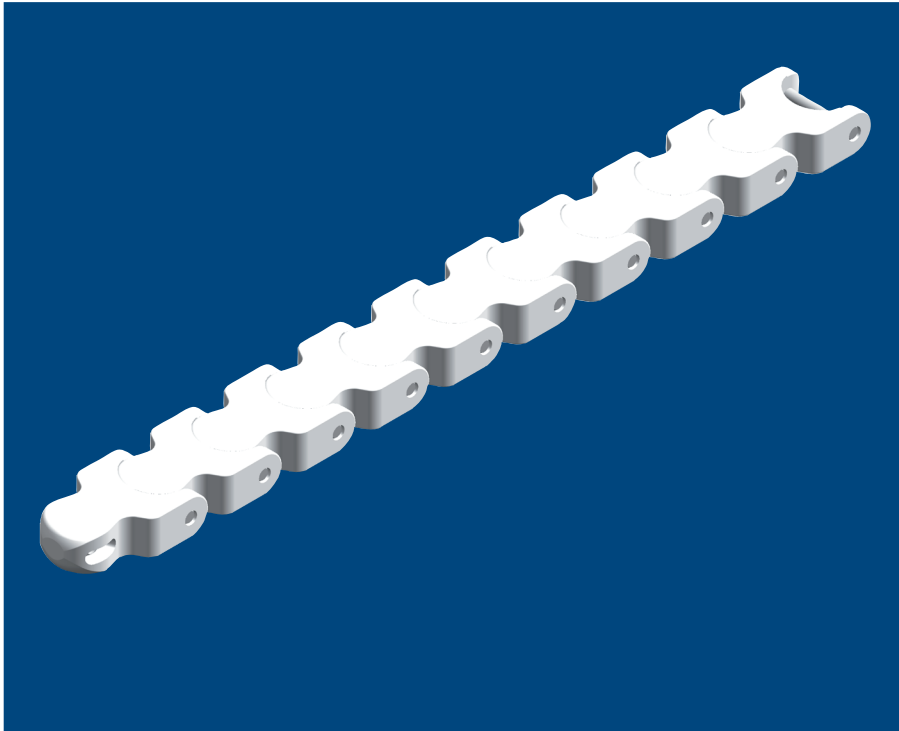

## KLDH50

A plastic chain. Recommended surrounding temperature is -18 — +50 °C. Recommended maximum work load at 20 °C is 200 kp/2000 N.

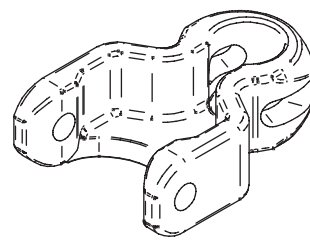
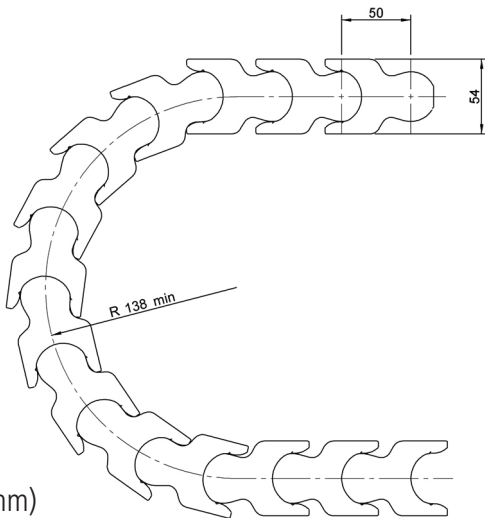

542586-0201-1

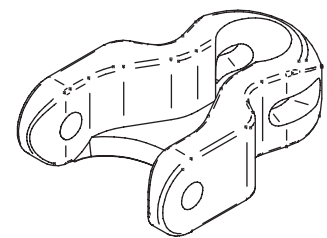

12007

Part number	Material	Length (L)	Weight	Width	Volume
542586-0201-1	POM	10 m per box	15 kg/10 m	54 mm	17.54 dm <sup>3</sup> /10 m
12007	Link: Low friction ACETAL Moisture pickup 0.2 % Rivet: Stainless steel Plunge: POLYAMID				

**Read more about our solutions for  
primary and secondary packaging  
in our product catalogue.**



Conveyor Solutions



 **FREDRIKSONS**



Fredriksons Verkstads AB • P.O Box 148 • SE-592 23 Vadstena  
Phone: +46 143 296 00 • Fax: +46 143 296 09  
info@fredriksons.se • [www.conveyorsolutions.se](http://www.conveyorsolutions.se)